

OCEAN FRONT VILLAS B1-C1 GROUND FLOOR

- Indoor Living 1,624 SF
- Outdoor Living 297 SF
- Single Level
- 2 Bedroom
- 2.5 Bath
- 9"+ Ft Ceilings
- Covered Terraces
- Fireplace
- Laundry Room
- Walk-In Closets
- Covered Car Garage

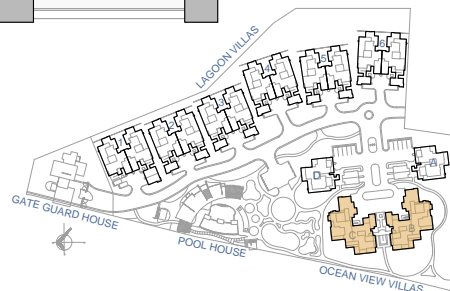

The developer reserves the right to make any modifications and changes as deemed necessary. Dimensions, sizes, specifications, furnishings, layouts, and materials are approximate only and subject to change without notice. Window sizes, layouts, configurations and ceiling heights may vary from home to home. Errors & omissions excepted. Additional disclosures available at <http://www.LivingCostaDivina.com>